

Submit your anchor record to
www.biganchorproject.com



Iron Stockless Anchor Recording Guidance Notes

Step 1: Upload Images

Ideally, five photographs are suggested, the most important one being an overall view of the anchor. The five suggested views are as follows:

- 1- Overall view showing the entire anchor from the front (both arms visible on each side).
- 2- View of the interior face (palm) of one fluke showing its shape.
- 3- Close-up view of one arm showing the shape of the arm.
- 4- Close-up view of the crown showing the welding of the two arms.
- 5- Close-up view of the upper area of the shank showing the ring, the stock key and other features.

Please do supply some descriptive text alongside each of the images that you upload.

NB: The max dimension of any image will be cropped to 150px (thumbnails) and 500px (main image). For best results, prepare a square photo cropped fairly tight on your subject. We can accept JPEG (.jpg), PNG (.png) and GIF (.gif) format images. For best results we recommend JPEG for photos and PNG for Black & White line drawings. Large files (bigger than 100kB) will take a long time to process, MAX file size = 500kB

Step 2: Location

This is simply where the site or anchor is geographically located. You can search for a location to Zoom in on the map. This comprises the name of the city/town, province/state/county, country and could include possible landmark (for example: Queens Road, Portsmouth, England; or Lighthouse Point, Louisbourg, Nova Scotia, Canada).

If you use the Satellite view in the Google Map you may be able to see your anchor if it is on display on land. This is a great way of pinpointing the exact location.

Once located, press **UPDATE LOCATION**

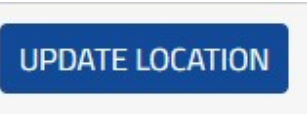

Latitude and longitude co-ordinates will be automatically generated



Step 3: Anchor Information

Recorders

Who recorded the anchor? Add the names of the people who recorded the anchor

Name of your club / organisation Add the name of the club, group or organisation undertaking the survey, if appropriate (eg. NAS, Weymouth Lunar Society, etc)

Date you recorded the anchor Use the calendar function to add the date the anchor was recorded.

Submit your anchor record to
www.biganchorproject.com



Context

Context and present status of the anchor

This defines the general context regarding the present status of this anchor. One of the following choices:

In situ on a wreck site	Anchor is still in situ on a wreck site (submerged or beached).
In site but isolated	Anchor is still in situ but forms an isolated site (submerged or beached).
In a museum or collection	Anchor is at a museum (exhibited inside/outside of).
On land	Anchor is on land (front lawn, park, etc.) but not associated with a wreck or a museum.
Treatise	Presented in a historical shipbuilding or maritime treatise (give reference in the comments box and in the description of the image uploaded).
Other	None of the above (give details in the box)

Name of site from which the anchor came

Name attributed to the site to which anchor is related. In the case of a wreck, it could be the name of the ship (if identity is known) or what the site is known as (for example: Channel wreck). In the case of a "land" anchor, this may be left blank.

Brief description of the physical location of the anchor

As you have already supplied co-ordinates this is simply a descriptive text box to supply any more useful information. For example: *The anchor is located against the wall of the Cricketeers Inn public house, right next to the entrance door.*

Name of Museum or collection and reference number

Archaeological or museum reference number if anchor has been excavated or catalogued. Left blank if not applicable

Are there any markings or lettering on your anchor?

This can be supplied here or later in the comments box

Is there a gravity band on the shank?

Not Recorded

Yes

No

A gravity band is often a shackle lower down the length of the shank which was used to help recover and stow the anchor alongside the vessel.

The gravity band is clearly visible on this anchor on display in Weymouth, Dorset, UK



Submit your anchor record to
www.biganchorproject.com



Shackle type

- Not present
- Crown Type
- Bow Type
- Ring

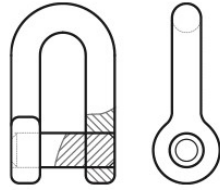

Crown Type

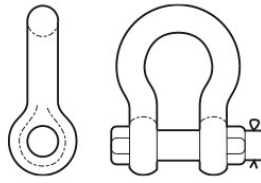

Bow Type



Ring

Chain link type

- Not present
- Twisted
- Studless
- Studded

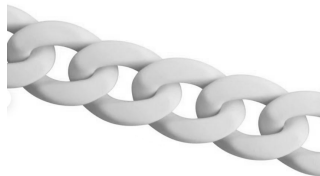

Twisted

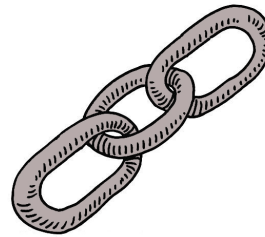

Studless



Studded

Stockless Anchor Type

Based on your anchor's shape and features choose between Type 1, Type 2 and Type 3

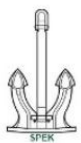
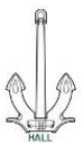

TYPE 1



TYPE 2

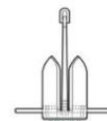

TYPE 3

Date and Origin

Most probable date

Absolute date of the anchor: in the case of a wreck, date of sinking; in the case of a treatise, date of publication. Can be left blank.

Confidence interval for the date (+/- years)

If you have an exact date then this is Zero. If you have rough idea of date then this could be 50 years.

Submit your anchor record to
www.biganchorproject.com



Nationality

Country of origin of the anchor (where the ship was built or outfitted, nation targeted by author of a treatise). Enter name of country (eg. France, and not French).

Degree of confidence in the date and origin of the anchor

Confirmed	There is no doubt as to the date and/or origin of the anchor (if it is definitely associated with an identified wreck).
Probable	Evidence, information or knowledge is indicating that it seems to be associated with a ship, but there information has not or cannot be verified.
Tentative	Information is fragmentary, hypothetical.
Unknown	No information.

Ship name Name of ship to which this anchor was associated, if known.

Ship type Type of ship (barque, frigate, schooner, etc.) associated with anchor, if known.

Ship size Size of ship (in tons) associated with anchor, if known. If not in tons, specify unit of measurement.

Comments Please add any reference or inscription details here alongside any general comments about the anchor)

NEXT

Step 4 – Dimensions

Note: All measurements should be taken in centimetres / millimetres eg 10.5cm (10cm 5mm) or 182.5cm (eg 1m 82cm 5mm)

Shank

Length of shank Length of shank from the extremity of the crown to the end of the shank.

Width at top of shank Maximum width of shank at the top of its length

Max width at bottom of shank Maximum width of shank at lowest point

Arms & Flukes

Length of one arm - A

Width of the fluke - B

Fluke tip to tip span - C

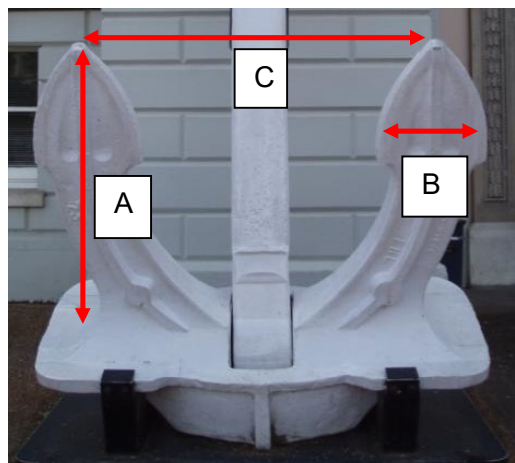

Submit your anchor record to
www.biganchorproject.com



Shackle (record only if present)

Length of shackle.

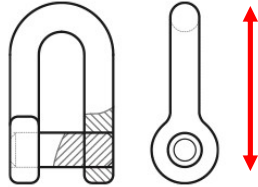

Width of shackle

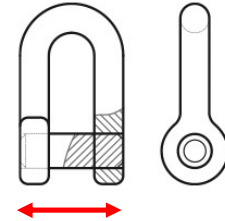

Tipping Spade & Base (Anchor Types 1 & 2 Only)

Width of tipping spade - A

Depth of tipping spade - B

Depth of base - C

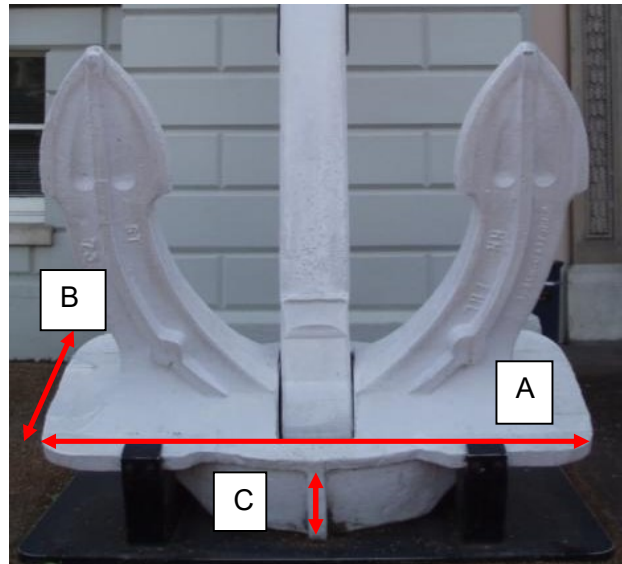

Now you are ready to submit your anchor record for
moderation by our Big Anchor Project administrators

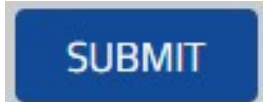

Thanks for taking part and helping to build a global database of anchors